



Emergency luminaire Art.-No.: FLU30ML

Robust ceiling-mounted Aluminium die-cast luminaire for the lighting of escape and rescue routes according to DIN EN 60598-1, DIN EN 605982-22 and EN 1838.

The IP66 flood light is suitable for indoor and outdoor use. Due to the wide beam angle, large areas can be easily illuminated. The MU05 monitoring module is installed in the supplied separate housing.



TECHNICAL DATA

Luminaire type	Emergency luminaire
Mounting	Universal
Pictograph	No
Illuminant	LED
Housing material	Zinc die-cast
Colour	RAL 7016
Mechanical rating IP	66
Impact resistance IK	8
Protection class	1
Supply	Central power supply system
Monitoring	ML - Central power supply system
Operation time	CPS
Operation mode	BS
Input Voltage AC	230 V
Input Frequency Hz	50 / 60 Hz
Input Voltage DC	216 V
Power consumption max.	31,5 W
Power consumption maintained	31,5 W
Power consumption non-maintained	1,5 W
Ambient temperature maintained mode	-25 °C / 40 °C



Ambient temperature non-maintained mode	-25 °C / 40 °C
Length	196 mm
Width	183 mm
Height	37 mm
Weight	4.7 kg
Weight incl. Packaging	4.7 kg
Switching input L'	No
Emergency light blocking	No
Battery connector	None
Dimming function	No
Luminous flux mains mode	4200 lm
Luminous flux emergency mode	4200 lm
Customs tariff number	94054210
Coutry of origin	CHINA
EAN	4260682159786



TECHNICAL DRAWING

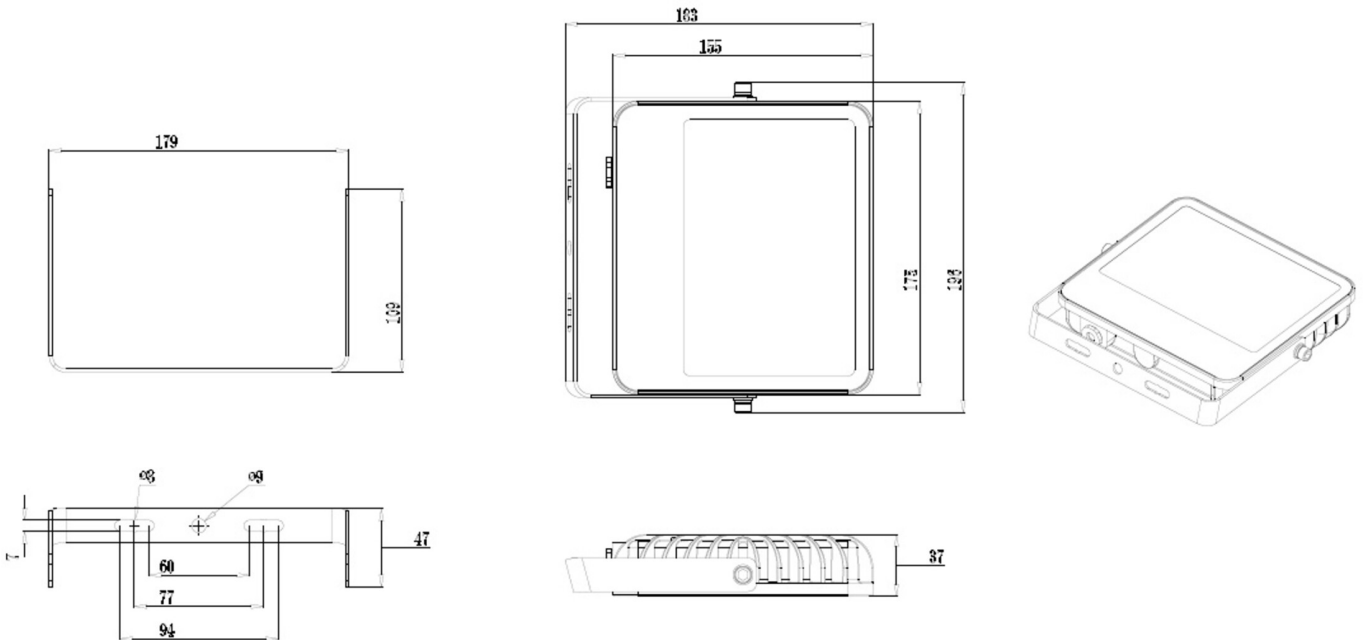

Maße MU05-BOX

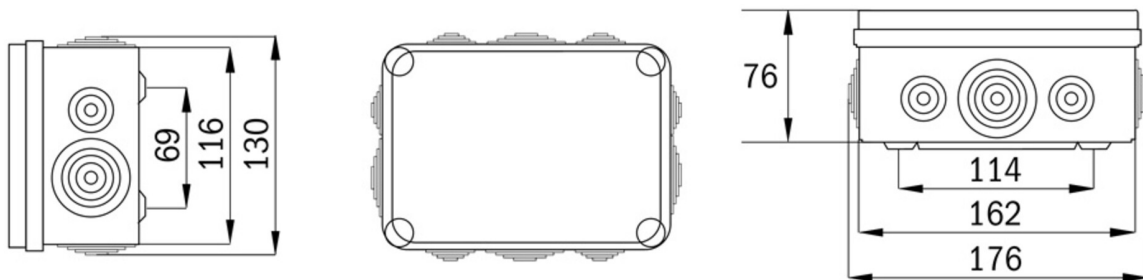

ACCESSORIES

MU05-BOX - monitoring module, CBS + ML / 230V AC/DC 4-200 VA